

# Kerotest Needle and Gauge Valves

## 200 Gauge Shutoff Valve



### Product Brief

A rugged, forged construction delivers dependable, leak-free performance at high and low pressures. Designed to measure and regulate flow in processing plants and oil and gas production applications, these valves perform in tight spaces and resist low-level corrosiveness. With optional trim, they also resist sour fluid environments, caustic liquids and corrosive media.

### Features/Benefits

- **Maximum operating pressure:** 10,000 psi @ 100° F (38° C).
- **Operation:** Bubble-tight shutoff for liquids or gas from 6,000 psi to 10,000 psi.
- **Body:** Rugged, forged body.
- **Flow:** Accurate flow control.
- **Stem material:** Precision-machined, heat-treated stem prevents sulfide stress cracking.
- **Handle:** Two-prong or easy-grip T-handles.
- **Connection:** Threaded pipe ends per ANSI B1.20.1.
- **Finish:** Stainless steel and clear zinc plating.
- **Assembly:** Replaceable seat assembly.
- **Safety:** Integral back-seated stem prevents accidental removal.



*An Employee-Owned Company*

# Kerotest Needle and Gauge Valves 200 Gauge Shutoff Valve

## Product Description

Description	200N Carbon Steel	200 ① Stainless Steel (Sour Gas Service)
Seat Ring	Integral	Integral
Body	ASTM-A105 ② · ASTM-A108 Gr. 1213 ②	ASTM-A182 Type F316
Stem	ASTM-A582 Type 416	17-4 PH Stainless Steel
Packing Nut	ASTM-A108 Gr. 1213 ②	ASTM-A276 Type 304
Gland	316 Stainless Steel	316 Stainless Steel
Packing Washer	AISI-C1010 ②	ASTM-A276 Type 304
Packing	Teflon® (500° F)	Teflon® (500° F)
Handle	Carbon Steel ③	Carbon Steel
Handle Nut	Plated Steel	Plated Steel

### Notes

- ① Complies with NACE Spec. MR-01-75 for sour gas and suitable for arctic service.
- ② Zinc plated.
- ③ Yellow zinc plated.

## Ordering Code/Specifications

Size	Catalog Number	Inlet Size Outlet Size	Body Material	Stem Material	Max. Temp.	Bonnet Type	Approx. Weight (lbs)
1/2"	<b>N-200N-35-004</b>	1/2" Male NPT	ASTM-A105 Carbon Steel	416 Stainless Steel ASTM-A582	500° F	Integral	1.50
	<b>P-200N-35-004</b>	1/2" Female NPT	ASTM-A108 AISI 1045 Carbon Steel	416 Stainless Steel ASTM-A582	260° C		1.50
1/2" NACE	<b>T-200N-35-004-A03</b>		ASTM-A182 316 Stainless Steel (NACE)	17-4 PH Stainless Steel (NACE)			1.50
	<b>N-200N-35-004-A06</b>		ASTM-A105 Carbon Steel	17-4 PH Stainless Steel (NACE)			1.50

## Dimensions

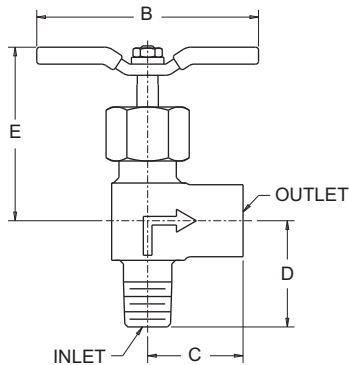

**Note:** Approximate dimensions in Inches (mm).

Size	A Width	B Handle Width	C CL-to-Outlet	D CL-to-Inlet	E CL-to-Top
1/2"	1.25 (31.8)	4.00 (101.6)	1.66 (42.2)	1.84 (46.8)	3.03 (77.0)

All product names referenced herein are trademarks of their respective companies.



### Kerotest Manufacturing Corp.

5500 Second Avenue • Pittsburgh, PA 15207  
412.521.7688 • Fax: 412.521.5990  
www.Kerotest.com • Sales@Kerotest.com